

HIPOT EMS Pre-set Pots

Miniature Types For Printed Circuits

Series PNZ11Z (10mm)

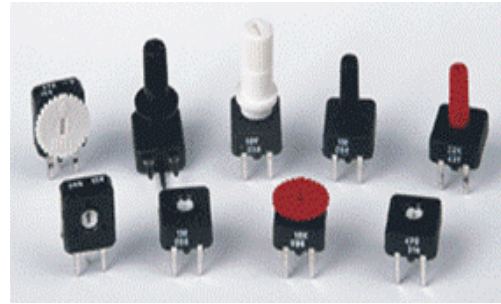

Description:

Pots & trimmers are designed for classical printed circuit board assemblies. Fixation is via soldering terminals. Functional options provide resistance ranges, temperature coefficients of resistance, electrical, physical and environmental characteristics that will meet virtually every demand, coupled with a wide variation of colored spindles and thumbwheels.

Features:

- ◆ Both side setting, insulated slider
- ◆ Carbon resistive element
- ◆ Dust proof enclosure

Ordering Example / Ser. PNCZ / 10 mm

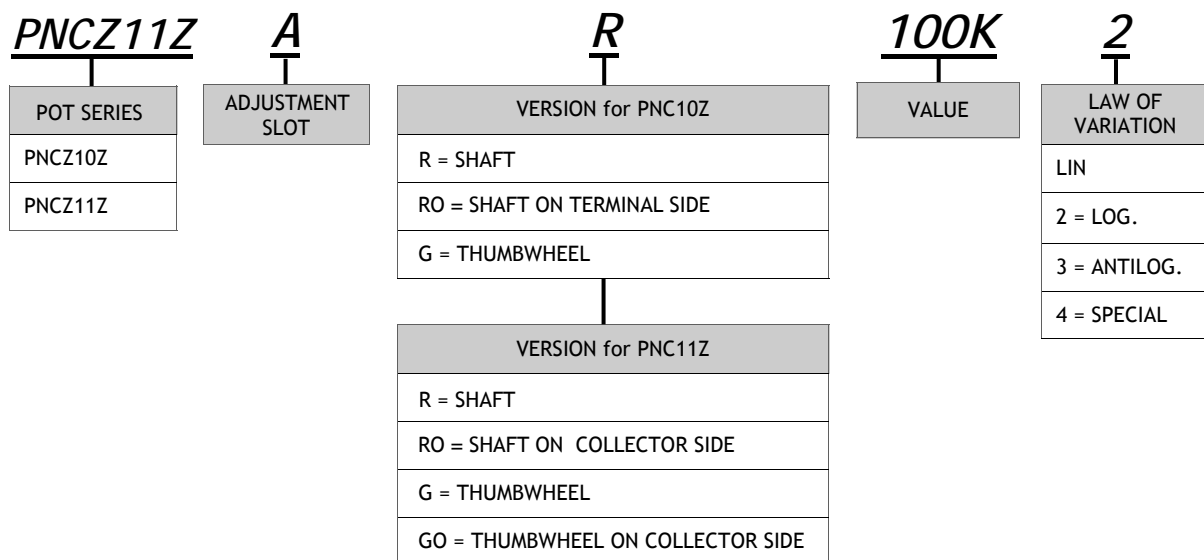

S.C.R. ELECTRONICS COMPONENTS.

PHONE: 972-3-5596755 FAX: 972-3-5596212 E-mail: sale_scr@bezeqint.net WEB: scr ltd.co.il

HIPOT EMS Pre-set Pots

Miniature Types For Printed Circuits

Series PNZ11Z (10mm)

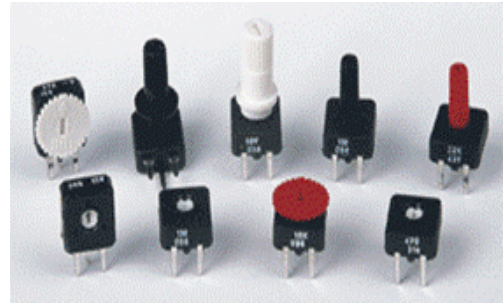

Electrical Characteristics:

- ◆ Maximum Voltage: lin 200V DC / log 150V DC
 - ◆ Operating Temperature: -25°C +70°C (-13°F + 158°F)
 - ◆ Rated Dissipation at 40°C: lin 0.15W / log 0.1W
 - ◆ Resistance Value Range: lin 100Ω to 10MΩ / log 1k to 2MΩ
 - ◆ Resistance Tolerance: (') ±20% for values $R \leq 1\text{M}\Omega$
(') ±30% for values $R \geq 1\text{M}\Omega$
- (*) On special request closer tolerance are available

Mechanical Characteristics:

- ◆ Electrical Rotation Angle: 240 ± 20° C
- ◆ End Stop Torque: > 50 mNm
- ◆ Mechanical Rotation Angle: 295 ± 5° C
- ◆ Operating Torque: 4 to 20 mNm
- ◆ Weight: 1.0 g approximate

Outline Drawing:

PNCZ11Z

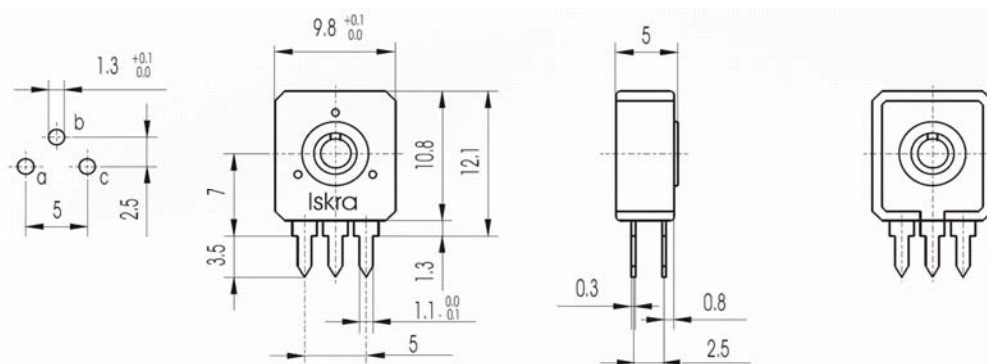

S.C.R. ELECTRONICS COMPONENTS.

PHONE: 972-3-5596755 FAX: 972-3-5596212 E-mail: sale_scr@bezeqint.net WEB: scr ltd.co.il