

| REV. | DESCRIPTION | DRAWN         | CHECKED | APPROVED |
|------|-------------|---------------|---------|----------|
| A    | NEW RELEASE | YCH 06/20/12' | ~       |          |
|      |             |               |         |          |
|      |             |               |         |          |

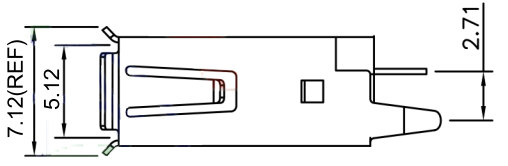

- NOTES:
- SPECIFICATIONS:
    - CONTACT RESISTANCE: 30mΩ max.
    - INSULATOR RESISTANCE: 1000MΩ min.AT DC 500V.
    - CURRENT RATING: 1.5A.
    - VOLTAGE RATING: 30V AC/DC.
    - DIELECTRIC STRENGTH: AC 500V FOR 1 Minute.
  - MATERIALS:
    - HOUSING: PBT+30% GLASS FIBER(UL 94-0).
    - CONTACT: COPPER ALLOY
    - SHELL: COPPER ALLOY.
  - PRODUCT NUMBER CODE:

BEND TYPE →

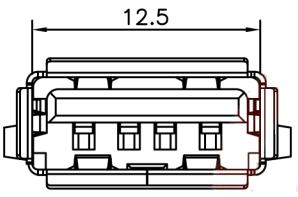
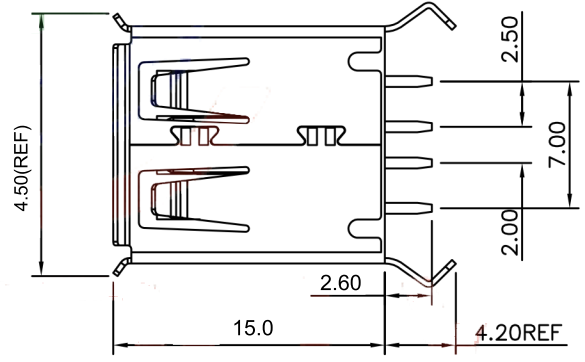

STRAIGHT TYPE →

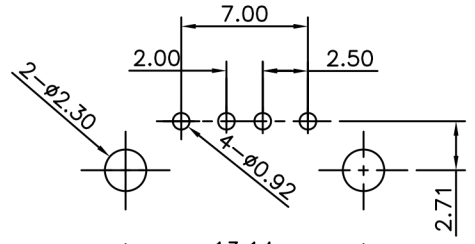
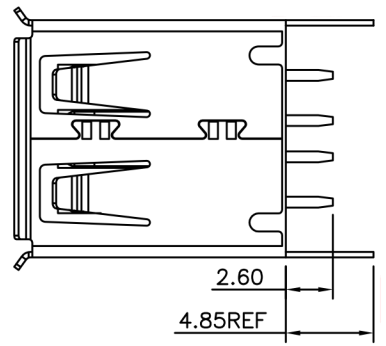

RECOMMEND PCB LAYOUT  
(TOLERANCE=±0.05)

|                   |       |                 |        |
|-------------------|-------|-----------------|--------|
| GENERAL TOLERANCE |       | ANGLE TOLERANCE |        |
| X.                | ±0.60 | X.              | ±5°    |
| .X                | ±0.38 | .X              | ±3°    |
| .XX               | ±0.25 | .XX             | ±2°    |
| DRAWING TYPE      |       | CUSTOMER        |        |
| SCALE             | 1:1   | SHEET           | 1 OF 1 |

|            |    |        |  |
|------------|----|--------|--|
| PROJECTION |    | TITLE  | USB A/F180° TYPE Single port Female TYPE |
| UNITS      | mm | SERIES |  |
| SHEET SIZE | A4 |        |  |

# USB1095-10