

DIN125A Washer

ISO 7089

Part#	Size	T	A	B
WF10XX03	M1.6	0.3	1.7	4
WF20XX03	M2	0.3	2.2	5
WF25XX03	M2.5	0.5	2.7	6
WF30XX03	M3	0.5	3.2	7
WF40XX03	M4	0.8	4.3	9
WF50XX03	M5	1	5.3	10
WF60XX03	M6	1.6	6.4	12
WF65XX03	M8	1.6	8.4	16
WF90XX03	M10	2	10.5	20

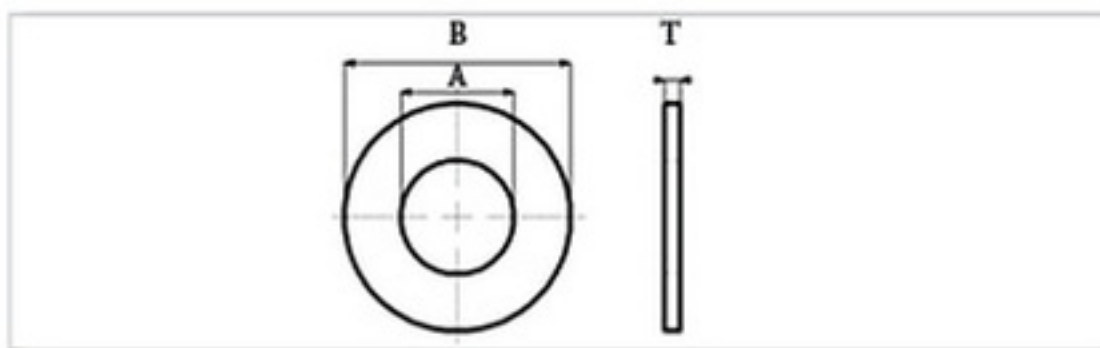

DIN 433 Flat washers

ISO 7092

Part#	Size	T	A	B
WF10XX06	M1,6	0,3	1,7	3,5
WF20XX06	M2	0.3	2.2	4.5
WF25XX06	M2.5	0.5	2.7	5
WF30XX06	M3	0.5	3.2	6
WF40XX06	M4	0.5	4.3	8
WF50XX06	M5	1	5.3	9.5
WF60XX06	M6	1.6	6.4	11
WF65XX06	M8	1.6	8.4	15
WF90XX06	M10	1.6	10.5	18

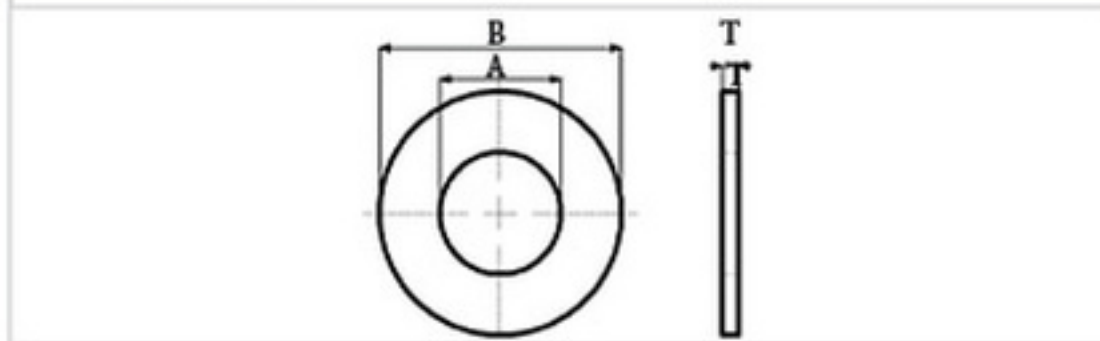

Sample Part Number

W	S	30	X	X	17
Type	Category	For Thread	Material	Plating	Standard
A	B	C	D	E	F

Spring washers: specifically designed to provide a compensating spring force and sustain a load or absorb a shock.

Internal and external washers. The internal style has the serrations along the inner diameter of the washer, which makes them more aesthetically pleasing. The external style have the serrations around the outer diameter, which provides better holding power, because of the greater surface area. the washers used with a soft substrate, such as aluminum or plastic.

A Type	Code
Washer	W

B Category	Code
spring Split lock washer	S
flat washer	F
Lock washer internal tooth	T
Lock washer external tooth	U

C For Thread	Code
M1.6	10
M2	20
M2.5	25
M3	30
M4	40
M5	50
M6	60
M8	65
M10	90

D Material Description	Code for Screws, Nuts, Washers
Low Carbon Steel	1
Stainless Steel (A2)	2
Brass	3
Aluminum	6

E Plating Description	Code for Screws, Nuts, Washers
Blue Zinc	2
Yellow Zinc	4
Black Zinc	7
No Plating	5
Passivated	6
Black Oxide	9
Nickel	8

F Standard	Code
DIN 125A	ISO 7089 03
DIN 9021	ISO 7093 12
DIN 433	ISO 7092 06
DIN 127B	NO ISO 04
DIN 6798J	NO ISO 14
DIN 6797A	NO ISO 07
DIN 6797J	NO ISO 08
DIN 6798A	NO ISO 16

For more information See page 138