

SLR-050L220-090

BULK & PACKING DIMENSIONS

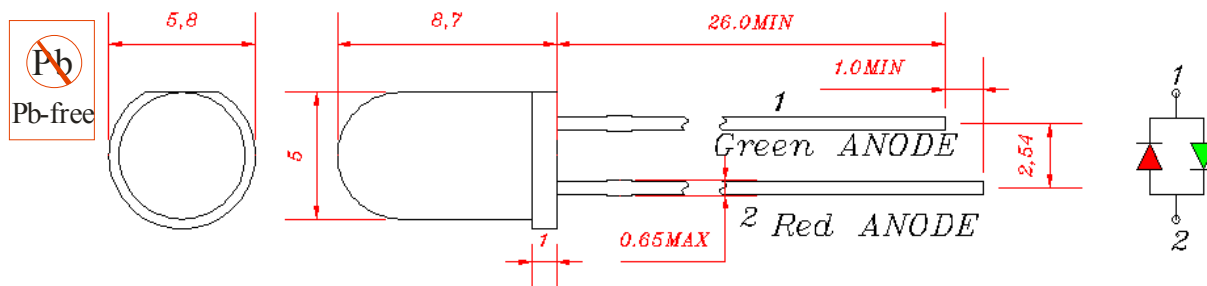

Selection Guide

	Chip :		Lens Color	Iv(mcd)(IF=20mA)			Viewing Angle (20½)
	Raw Material	Emitted Color		MIN	TYP	MAX	
	AlGaInP	Red	Milky	30	50	-	50°
	AlGaInP	Yellow Green		30	50	-	50°

Absolute Maximum Ratings(Ta=25C°)

Item	Symbol	Maximum	Unit
Power Dissipation	PD	R	65
		G	65
Peak Forward Current (1/10 Duty Cycle 0.1ms Pulse Width)	IFP	R	160
		G	140
Continuous Forward Current	IFmax	25	mA
Reverse Voltage	VR	5	V
Capacitance	C	R	15
		G	15
Operating / Storage Temperature Range	Topr / Tstg	-40°C to +85°C	
Lead Solder Temperature	Tsol	260°C for 3 seconds	

Electrical / Optical Characteristics(Ta=25C°)

Item	Symbol	Min.		Typ.		Max.		Unit	Condition
		R	G	R	G	R	G		
Peak Wavelength	λ_p	-	-	650	568	-	-	nm	IF=20mA
Dominant Wavelength	λ_d	635	565	645	572	645	575	nm	IF=20mA
Forward Voltage	VF	1.8	1.8	2.0	2.20	2.60	2.60	V	IF=20mA
Reverse Current	IR	-	-	-	-	10	10	uA	VR=5V

NOTES:

- All dimensions are in millimeter(inch);
- Tolerance is $\pm 0.25\text{mm}(0.01")$ especially other specified; Luminous intensity tolerance is $\pm 10\%$;
- Dominant Emission Wavelength tolerance is $\pm 5\%$; Specifications are subject to change without notice.