

WK7

Characteristics

Initial contact resistance	25mΩ max	
Initial insulation resistance	100 MΩ min.(At 500V DC)	
Dielectric strength	Between non-consecutive terminals	1,000Vrms,50/60Hz for 1 min
	Between non-current carrying metal parts and each terminal	1,500Vrms,50/60Hz for 1 min
	Between ground and each terminal	1,500Vrms,50/60Hz for 1 min
Shock resistance	Destruction	O.F.>0.5N:1000m /s ² (Approx.100G)max. O.F.≤0.5N:400m/s ² (Approx.40G)max.
	Malfunction	O.F.>0.5N:200m/s ² (Approx.20G)max O.F.≤0.5N:100m/s ² (Approx.10G)max.
Vibration resistance	10-55Hz,1.5mm double amplitude	
Operating life	Mechanical life	1,000,000 operations min

	Electrical life	50,000 operations min
Ambient temperature	-25°C to +85°C	
Ambient humidity	≤85%RH	
Operating frequency	Mechanical	60 times/min
	Electrical	25 times/min
Operating speed	0.1mm-1m/s	
Protection degree	IP40	

The WK7 series micro switch is a versatile and reliable component with a compact design and responsive action suitable for a wide range of applications. Featuring a variety of levers and terminal blocks, this microswitch can be customized to meet specific requirements, making it ideal for tight spaces and diverse operating needs. Their long service life and high reliability help reduce operating costs, while their availability in multiple ratings and temperature classes further enhances their adaptability. WK7 series micro switches are widely used in household appliances, electronic equipment, automotive electronics, automation and other fields. They have obtained CE, CQC, UL, VDE, ENEC and other certifications to ensure compliance with international standards.

One of the key features of the WK7 series microswitch is its ability to accommodate different lever configurations. Lever switches are usually installed with a universal button coded "0", and the lever can be customized according to specific needs. This flexibility allows for seamless integration into a variety of devices and devices, enhancing overall functionality and user experience. In addition, the operating force of the micro switch is measured from the button position without a lever, and the operating force with a lever is converted according to its corresponding lever. This customization extends to other operational forces and can be tailored to specific operational requirements, providing tailor-made solutions for different applications.

The compact design of the WK7 series micro switches makes them particularly suitable for applications where space is limited. Its responsive action ensures precise and reliable operation, helping to improve the overall efficiency and performance of installed equipment. In addition, the long service life and high reliability of micro switches not only reduce maintenance and replacement costs, but also contribute to the seamless operation of the equipment in which they are used. This reliability is further emphasized by the availability of various nominal parameter values and temperature resistance levels, allowing the most suitable configuration to be selected for a specific application, thereby increasing its overall performance and durability.

The WK7 series of micro switches provide a compact, reliable and customizable solution for a variety of applications. Its versatility, responsiveness and long service life make it an ideal choice for household appliances, electronic equipment, automotive electronics, automation and other fields. With its various certifications and adaptability to different lever configurations, the WK7 series of micro switches stand out as reliable and efficient components that enhance the performance and functionality of a wide range of installations and equipment.

WK7-1

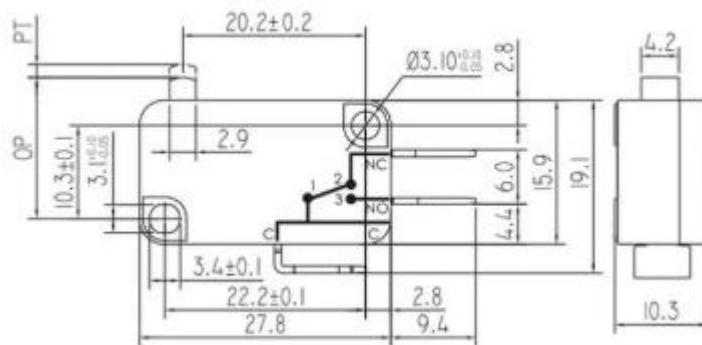

WK7-9

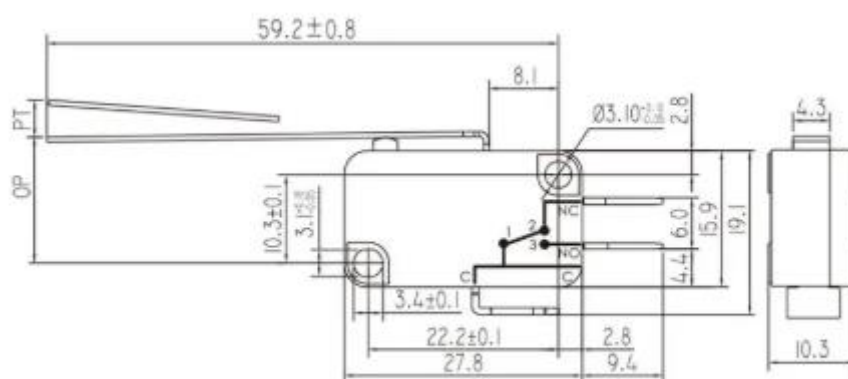

Rating

Code	
Rating	16A,125/250V AC

Other rating without of this form can be customized by requirement.